

UNITED STATES OF AMERICA
BEFORE THE FEDERAL ENERGY REGULATORY COMMISSION

**FINAL APPLICATION FOR NEW LICENSE FOR MAJOR PROJECT –
EXISTING DAM**

**EXHIBIT G – PROJECT
BOUNDARY MAPS**

Prepared by:  **GOMEZ AND SULLIVAN**
ENGINEERS

July 2020

©Copyright 2020. New York Power Authority. All Rights Reserved

**GREGORY B. JARVIS PROJECT
RELICENSING**

FERC NO. 3211



**NY Power
Authority**

Table of Contents

1	Detailed Maps	1
2	Project Boundary	2
3	Federal Lands	3
4	Non-Federal Lands	4
5	Project Boundary Data.....	5

1 Detailed Maps

Exhibit G provides maps showing the Project boundary enclosing the Gregory B. Jarvis Power Project (Project), as described in Exhibit A. The maps conform to the requirements of Section 4.41(h) of the Federal Energy Regulatory Commission’s (FERC or the Commission) regulations. Maps of the Project Area showing principal Project features and the Project boundary are included.

2 Project Boundary

The Project boundary is shown on the attached Exhibit G maps. The Project boundary includes all lands necessary for operation and maintenance of the Project. The Applicant possesses property or easement rights to all areas associated with the defined Project boundary.

The Applicant is proposing modifications to the current Project Boundary. The proposed Project boundary has been extended to include the Power Authority Boat Launch parking lot, the access road leading from NYS Route 365 to the Powerhouse, and the Project interconnection point at the switchyard north of NYS Route 365. The addition of this FERC mandated facility increases the Project boundary to 2,799 acres. The proposed Project boundary is shown on the attached Exhibit G maps.

3 Federal Lands

There are no public lands or reservations of the United States within the Project boundary.

4 Non-Federal Lands

The Power Authority has acquired, either through fee, easement, or lease, all land rights necessary to operate the Project. Land to which the Power Authority holds title or right is identified on the attached Exhibit G maps.

5 Project Boundary Data

Point No.	Direction	Distance (feet)	NAD83 New York State Plane East	
			North (feet)	East (feet)
1			1629422.686	330344.3277
2	N 88-34-57 W	242.7	1629428.69	330101.7015
3	S 49-9-46 W	186.884	1629306.484	329960.3111
4	N 75-52-49 W	186.78	1629352.049	329779.174
5	N 53-55-20 E	255.274	1629502.376	329985.4911
6	N 53-55-19 E	122.824	1629574.705	330084.7596
7	N 0-11-28 W	2266.172	1631840.864	330077.2058
8	N 88-57-42 W	67.752	1631842.092	330009.4652
9	N 88-57-43 W	70.766	1631843.374	329938.7107
10	N 46-6-29 W	72.263	1631893.474	329886.6347
11	N 89-53-19 W	30.175	1631893.532	329856.4602
12	N 4-23-31 W	282.208	1632174.912	329834.8497
13	S 81-24-25 W	256.688	1632136.558	329581.0431
14	N 88-44-20 W	276.109	1632142.635	329305.0013
15	N 33-20-26 W	39.485	1632175.621	329283.2999
16	R = 1032.53	L = 224.41	1632177.357	329507.2585
17	S 3-22-0 E	14.783	1632162.6	329508.1266
18	R = 1258.07	L = 540.50	1632354.44	330008.9944
19	R = 1623.51	L = 82.86	1632412.46	330068.1389
	N 5-9-34 W	88.171		

Point No.	Direction	Distance (feet)	NAD83 New York State Plane East	
			North (feet)	East (feet)
20			1632500.274	330060.2098
	S 50-5-32 W	124.48		
21			1632420.413	329964.7238
	R = 125.81	L = 94.24		
22			1632512.426	329962.1195
	N 64-32-11 W	20.191		
23			1632521.107	329943.8902
	N 25-5-30 E	120.772		
24			1632630.482	329995.1056
	S 72-38-46 E	29.103		
25			1632621.802	330022.8834
	R = 216.82	L = 222.93		
26			1632723.364	330210.3834
	R = 967.55	L = 239.49		
27			1632521.975	330081.9112
	S 6-14-59 E	85.679		
28			1632436.805	330091.2383
	R = 1623.50	L = 293.97		
29			1632669.028	330270.8265
	N 21-22-21 E	87.749		
30			1632750.743	330302.8048
	N 27-58-16 E	198.3		
31			1632925.878	330395.8128
Tie Line	N 0-5-2 W	1596.573		
	Follows Elevation 1225' (BCD) in between points 31 and 32			
32			1634522.45	330393.4765
	N 63-59-2 W	25.04		
33			1634533.433	330370.9736
	R = 1301.72	L = 423.01		
34			1634930.467	330511.4474
	N 25-58-31 E	85.569		
35			1635007.392	330548.925
	S 74-58-56 E	99.554		
36			1634981.595	330645.079
	S 68-0-19 E	161.015		
37			1634921.292	330794.3747
Tie Line	S 4-40-45 W	5516.993		
	Follows Elevation 1225' (BCD) within Hinckley Reservoir to point of beginning			

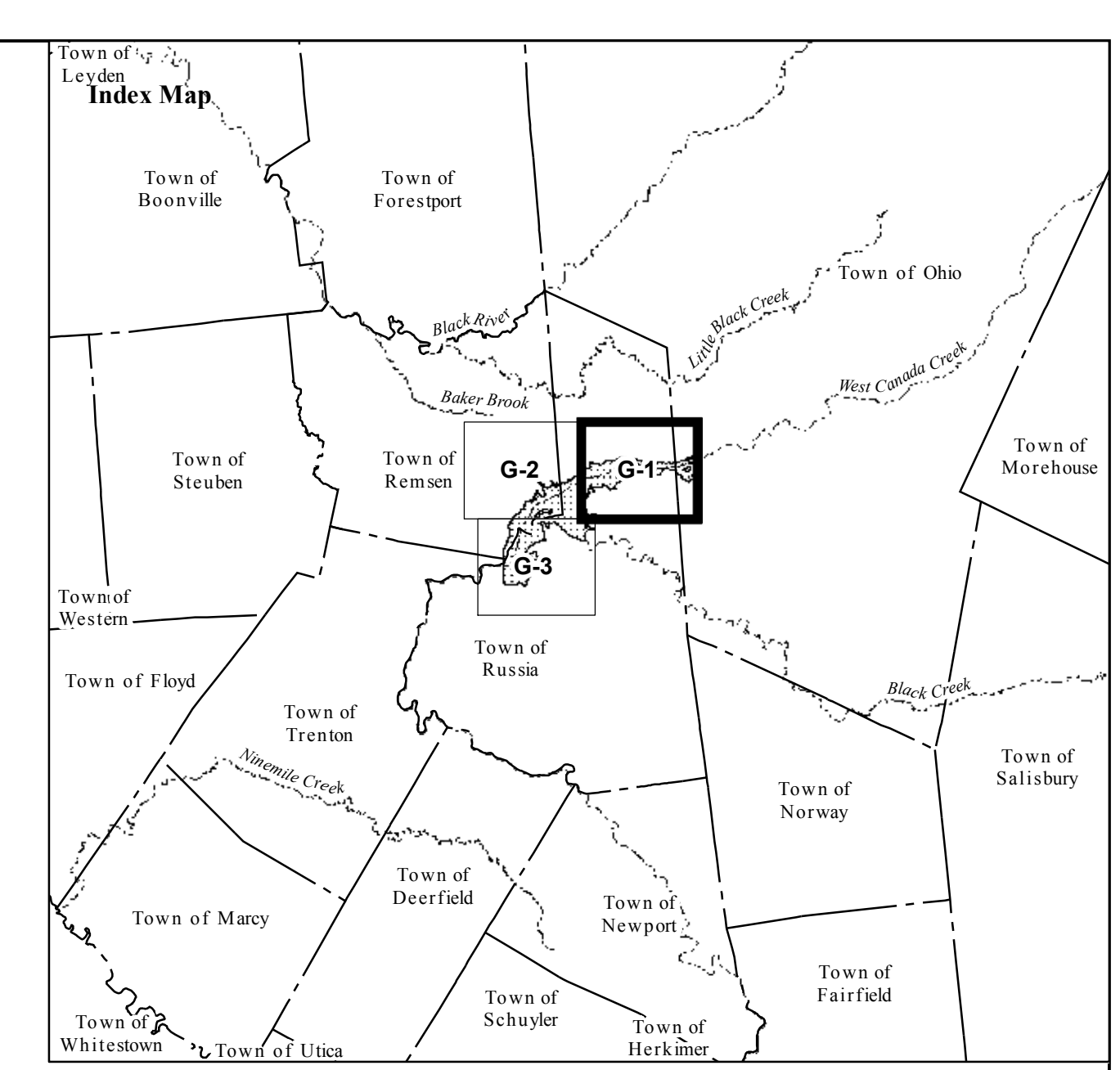
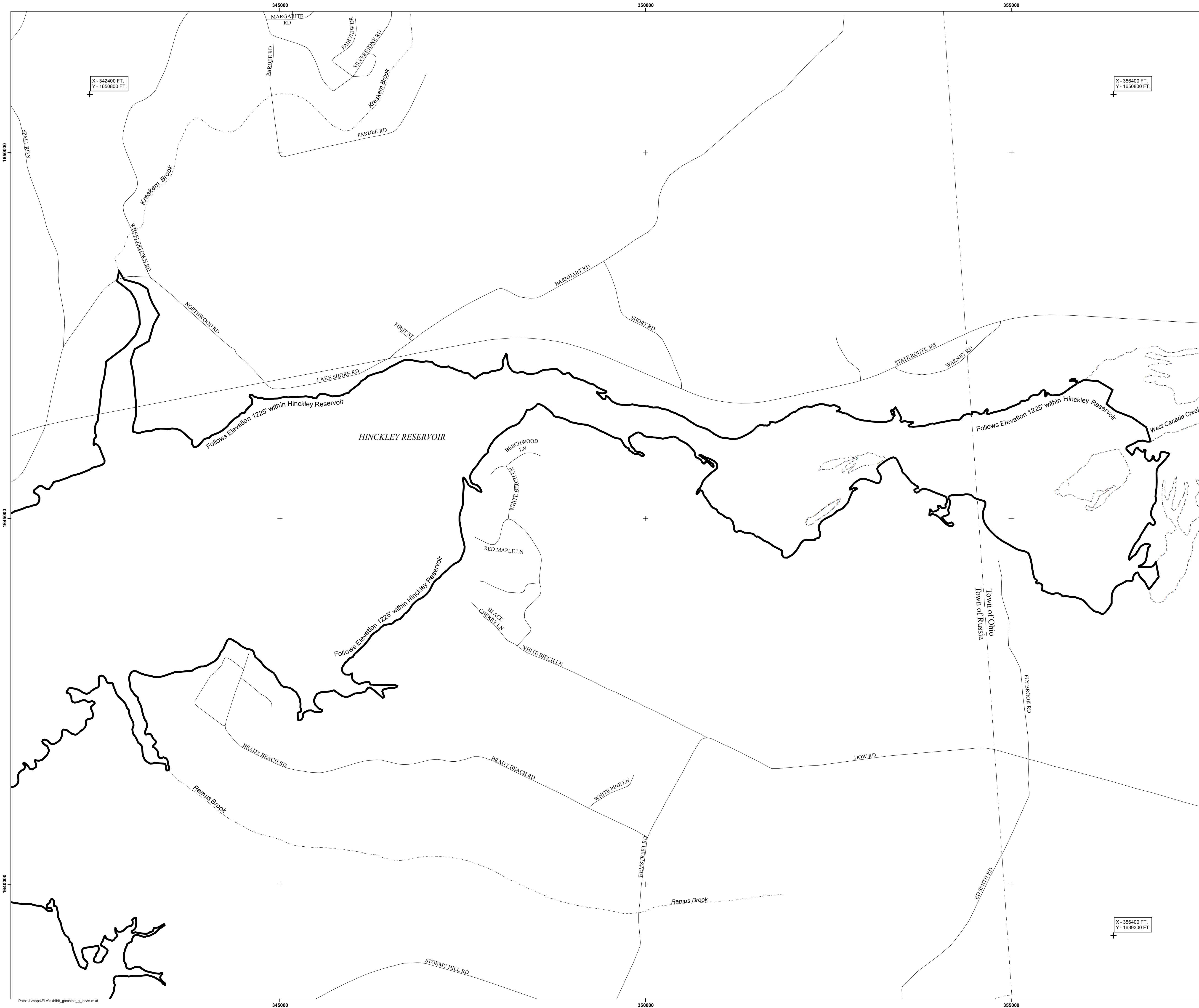

Legend

	FERC Project Boundary		Reference Point
	Project Boundary Points (See Table for meters and bounds)		Formal Recreation Site (NYPA Managed)
	Body of Water		

GENERAL NOTES:

- The project boundary depicted herein is based largely on a certain map entitled "State of New York Department of Transportation, Map Showing Abandoned Hydroelectric Easement Over Barge Canal Lands in the Towns of Trenton, Remsen, Russia & Ohio, Counties of Oneida and Herkimer" filed in the records of the Power Authority of the State of New York as "Jarvis Project, Power Authority of the State of New York, Map No. OT-1, Parcel No. 1", dated December 19th, 1983.
- All lands and waters within the project boundary depicted herein are controlled through a hydroelectric easement conveyed to the Power Authority of the State of New York by the People of the State of New York by indenture dated March 21, 1984, recorded in the Department of State in Volume 26 of Miscellaneous Records at Page 72.
- The map projection for Sheets 1 through 3 is the New York State Plane Coordinate System, East Zone, units U.S. survey feet.
- The horizontal datum for the base map data on Sheets 1 through 3 is the North American Datum of 1983, also known as NAD 83.
- The vertical datum for this Exhibit G is the Barge Canal Datum (BCD).
- The project boundary perimeter description is contained in the Exhibit G Project Boundary Description Table with the Final License Application.
- The portion of the project boundary defined by elevation contour 1225' BCD was developed through photo interpretation using digital orthophotography that meets or exceeds the accuracy requirements in 18CFR4.41. Photo interpretation is inherently subjective. No field surveys have been performed to confirm the boundary locations shown herein.

I CERTIFY THAT THE PROJECT BOUNDARY DELINEATION SHOWN HEREON IS DEVELOPED FROM RECORD PLANS, MAPS, AND DIGITAL ORTHOPHOTOGRAHY IN THE FILES OF THE POWER AUTHORITY OF THE STATE OF NEW YORK AND THAT SAID BOUNDARY DELINEATION MEETS THE ACCURACY REQUIREMENTS IN 18CFR4.41 SUBJECT TO THE POTENTIAL VARIATION CITED IN GENERAL NOTE 7 ABOVE.

John Lavern Thompson
 JOHN LAVERN THOMPSON N.Y.S.L.S. NO. 050248-1
 SURVEYING AND MAPPING COORDINATOR
 POWER AUTHORITY OF THE STATE OF NEW YORK

New York Power Authority
 Gregory B. Jarvis Hydroelectric Project
 FERC No. 3211

SHEET 1 of 3

1 inch = 600 feet

EXHIBIT G-1

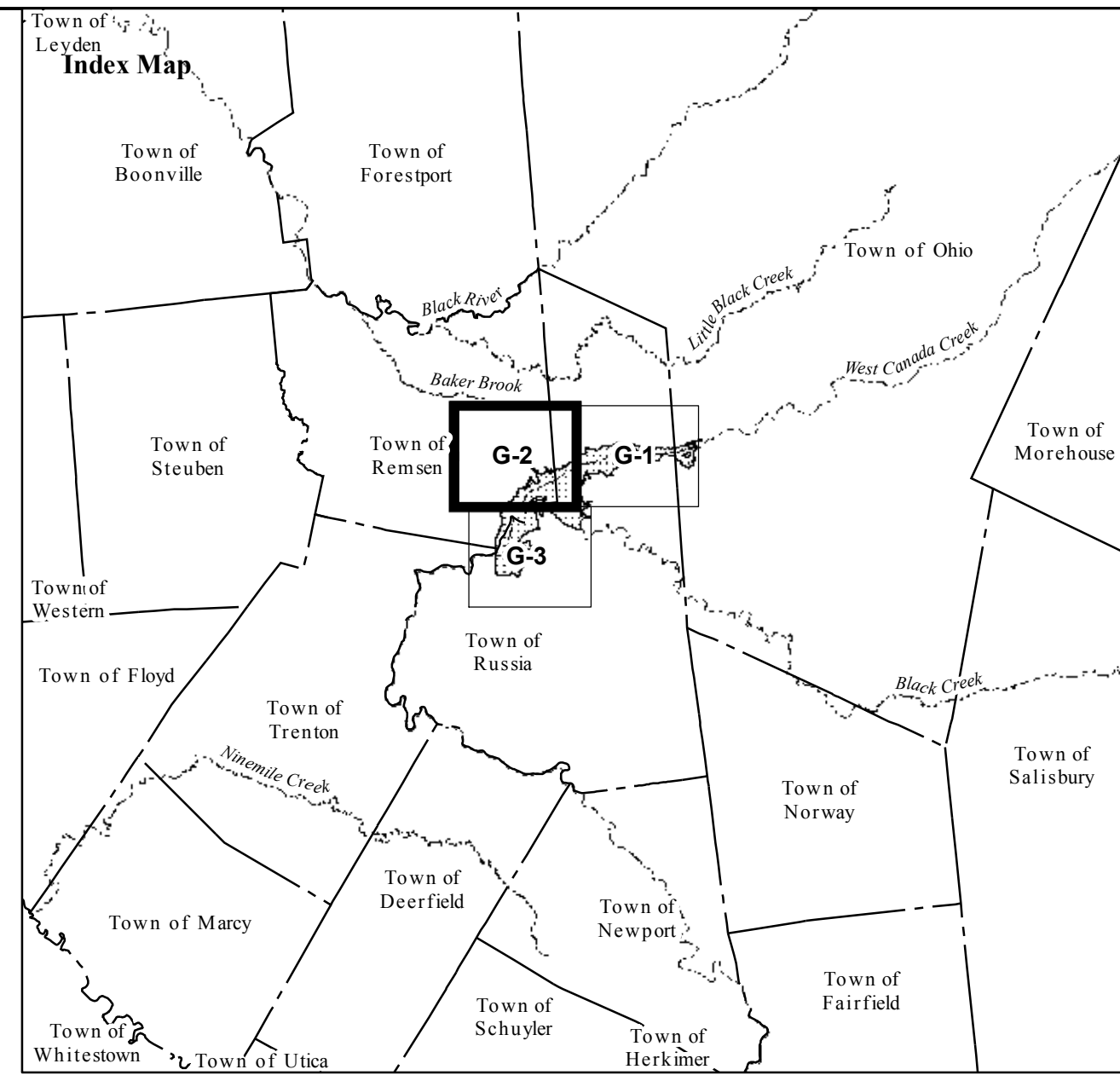

Legend

	FERC Project Boundary		Reference Point
	Project Boundary Points (See Table for metes and bounds)		Formal Recreation Site (NYPA Managed)
	Body of Water		

GENERAL NOTES:

- The project boundary depicted herein is based largely on a certain map entitled "State of New York Department of Transportation, Map Showing Abandoned Hydroelectric Easement Over Barge Canal Lands in the Towns of Trenton, Remsen, Russia & Ohio, Counties of Oneida and Herkimer" filed in the records of the Power Authority of the State of New York as "Jarvis Project, Power Authority of the State of New York, Map No. OT-1, Parcel No. 1", dated December 19th, 1983.
- All lands and waters within the project boundary depicted herein are controlled through a hydroelectric easement conveyed to the Power Authority of the State of New York by the People of the State of New York by indenture dated March 21, 1984, recorded in the Department of State in Volume 26 of Miscellaneous Records at Page 72.
- The map projection for Sheets 1 through 3 is the New York State Plane Coordinate System, East Zone, units U.S. survey feet.
- The horizontal datum for the base map data on Sheets 1 through 3 is the North American Datum of 1983, also known as NAD 83.
- The vertical datum for this Exhibit G is the Barge Canal Datum (BCD).
- The project boundary perimeter description is contained in the Exhibit G Project Boundary Description Table with the Final License Application.
- The portion of the project boundary defined by elevation contour 1225' BCD was developed through photo interpretation using digital orthophotography that meets or exceeds the accuracy requirements in 18CFR4.41. Photo interpretation is inherently subjective. No field surveys have been performed to confirm the boundary locations shown herein.

I CERTIFY THAT THE PROJECT BOUNDARY DELINEATION SHOWN HEREON IS DEVELOPED FROM RECORD PLANS, MAPS, AND DIGITAL ORTHOPHOGRAPHY IN THE FILES OF THE POWER AUTHORITY OF THE STATE OF NEW YORK AND THAT SAID BOUNDARY DELINEATION MEETS THE ACCURACY REQUIREMENTS IN 18CFR4.41 SUBJECT TO THE POTENTIAL VARIATION CITED IN GENERAL NOTE 7 ABOVE.

Jon Lavern Thompson
 JON LAVERN THOMPSON N.Y.S.L.S. NO. 050248-1
 SURVEYING AND MAPPING COORDINATOR
 POWER AUTHORITY OF THE STATE OF NEW YORK

New York Power Authority
 Gregory B. Jarvis Hydroelectric Project
 FERC No. 3211

SHEET 2 of 3

EXHIBIT G-2
 1 inch = 600 feet

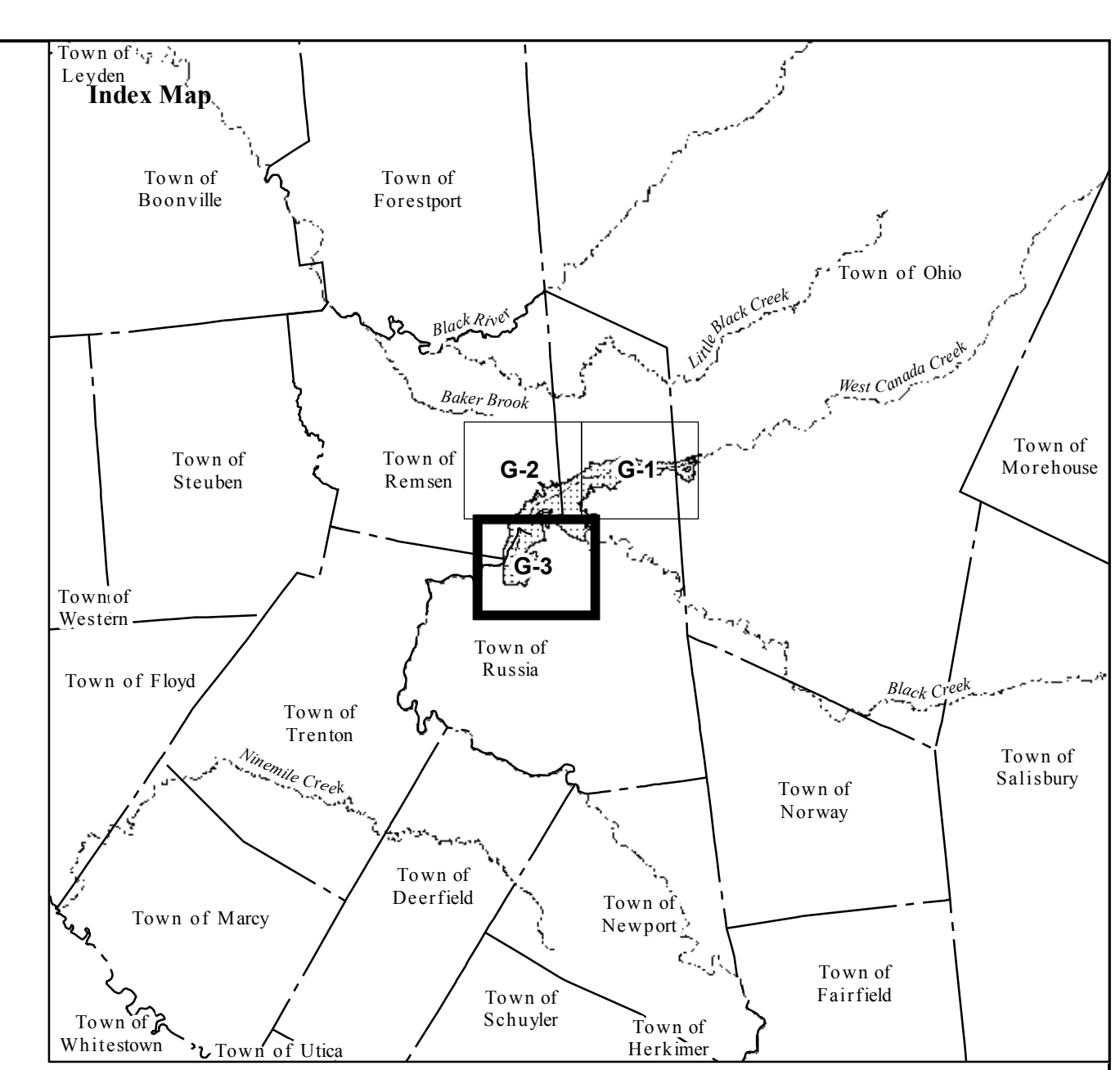
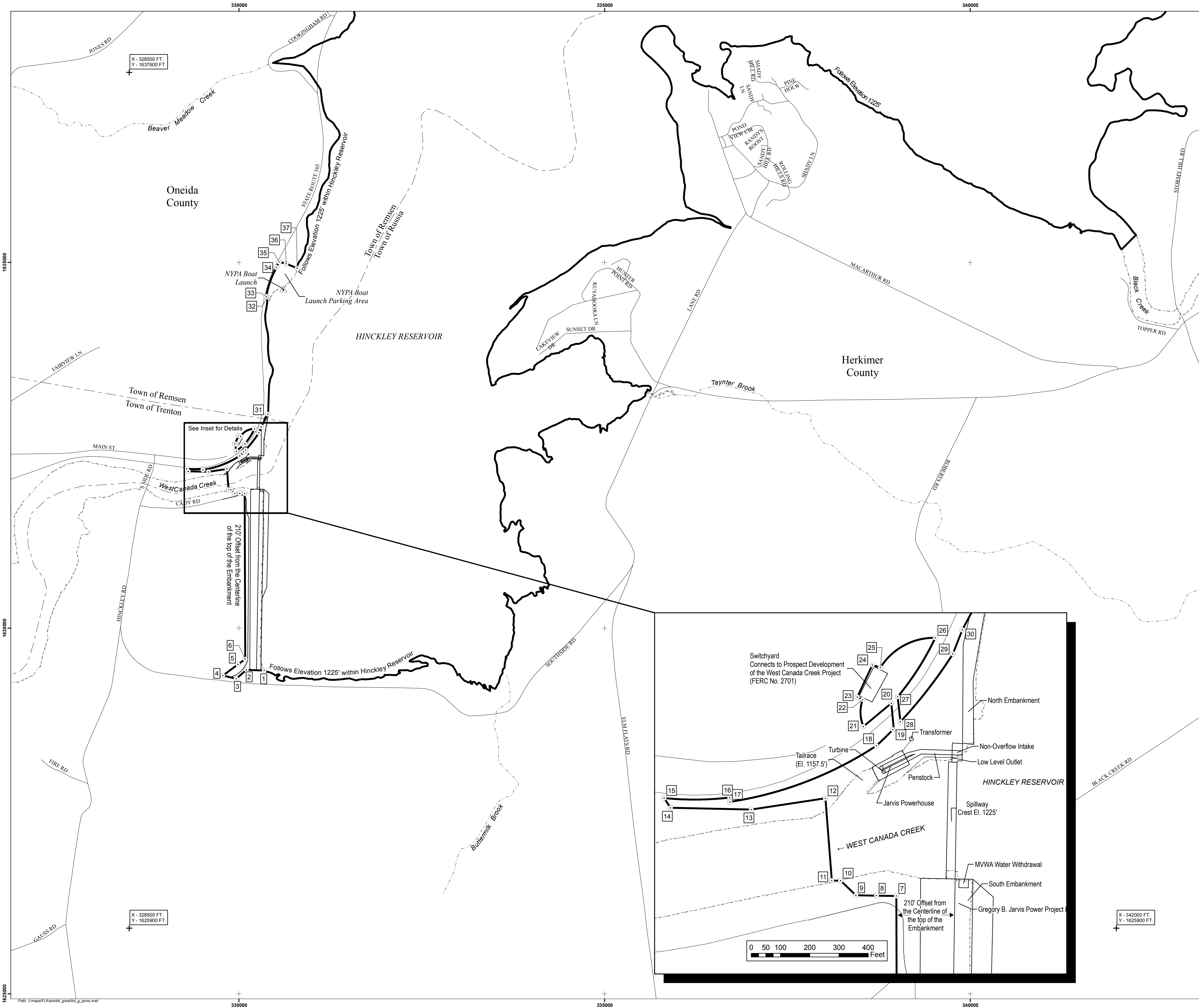

Legend

	FERC Project Boundary		Reference Point
	Project Boundary Points (See Table for metes and bounds)		Formal Recreation Site (NYPA Managed)
	Body of Water		

- GENERAL NOTES:**
- The project boundary depicted herein is based largely on a certain map entitled "State of New York Department of Transportation, Map Showing Abandoned Hydroelectric Easement Over Barge Canal Lands in the Towns of Trenton, Remsen, Russia & Ohio, Counties of Oneida and Herkimer" filed in the records of the Power Authority of the State of New York as "Jarvis Project, Power Authority of the State of New York, Map No. OT-1, Parcel No. 1", dated December 19th, 1983.
 - All lands and waters within the project boundary depicted herein are controlled through a hydroelectric easement conveyed to the Power Authority of the State of New York by the People of the State of New York by indenture dated March 21, 1984, recorded in the Department of State in Volume 26 of Miscellaneous Records at Page 72.
 - The map projection for Sheets 1 through 3 is the New York State Plane Coordinate System, East Zone, units U.S. survey feet.
 - The horizontal datum for the base map data on Sheets 1 through 3 is the North American Datum of 1983, also known as NAD 83.
 - The vertical datum for this Exhibit G is the Barge Canal Datum (BCD).
 - The project boundary perimeter description is contained in the Exhibit G Project Boundary Description Table with the Final License Application.
 - The portion of the project boundary defined by elevation contour 1225' BCD was developed through photo interpretation using digital orthophotography that meets or exceeds the accuracy requirements in 18CFR4.41. Photo interpretation is inherently subjective. No field surveys have been performed to confirm the boundary locations shown herein.

I CERTIFY THAT THE PROJECT BOUNDARY DELINEATION SHOWN HEREON IS DEVELOPED FROM RECORD PLANS, MAPS, AND DIGITAL ORTHOPHOTOGRAHY IN THE FILES OF THE POWER AUTHORITY OF THE STATE OF NEW YORK AND THAT SAID BOUNDARY DELINEATION MEETS THE ACCURACY REQUIREMENTS IN 18CFR4.41 SUBJECT TO THE POTENTIAL VARIATION CITED IN GENERAL NOTE 7 ABOVE.

Jon Lavern Thompson
 JON LAVERN THOMPSON N.Y.S.L.S. NO. 050248-1
 SURVEYING AND MAPPING COORDINATOR
 POWER AUTHORITY OF THE STATE OF NEW YORK



New York Power Authority
 Gregory B. Jarvis Hydroelectric Project
 FERC No. 3211

SHEET 3 of 3

0 300 600 1,200 1,800 2,400
 Feet

EXHIBIT G-3
 1 inch = 600 feet